

SKY VILLA 1

4 BEDROOMS | 4.5 BATHROOMS
LIBRARY | TERRACE | HOT TUB



THE JEWEL OF MIAMI

A ONCE IN A GENERATION ADDRESS

JEM stands as a remarkable architectural marvel.

Crafted by the renowned Miami-based firm Arquitectonica, this majestic tower soars to a height of 770 feet above sea level. Drawing inspiration from the neighboring ocean landscape, its silhouette mirrors the wavelike rhythm, embodying the spirit of innovation that defines this vibrant city. Within its walls, the interiors of JEM unfold as a masterpiece, envisioned by the creative masterminds of Naftali Group and the esteemed Rockwell Group.

A world unto itself, the building houses the illustrious JEM Club—an exclusive private haven boasting an unparalleled array of city-centric amenities. Ascending further, a series of luxurious residences starting on the 43rd floor, replete with sweeping wraparound terraces, seamlessly merge indoor and outdoor spaces, offering a truly opulent living experience.



THE HIGHEST FORM OF CRAFTSMANSHIP

AN INSPIRED COLLABORATION
WITH FENDI CASA

Crowning the sculptural JEM tower, the exclusive collection of two spectacular Sky Villas is a culmination of a visionary collaboration with Fendi Casa. Inspired by Miami's essential visual language, every piece and object traces the heritage that has always fused fashion, architecture, craftsmanship, and haute design. Spanning the top two floors of the sculptural tower, the residences encompass four bedrooms and four-and-a-half bathrooms—suspended above the endless panoramic views of Downtown Miami, Miami Beach, Brickell, and Edgewater.





“Inspired by FENDI’s rich heritage in Rome, with the FENDI Casa team we hand-selected and custom-finished each piece to complement the lifestyle that the Sky Villa residences offer.”

DANIELLE NAFTALI
EXECUTIVE VICE PRESIDENT
MARKETING, SALES & DESIGN
NAFTALI GROUP









RESIDENTIAL FEATURES

- » Each of the two expansive Sky Villas at the building's crown feature four bedrooms and a library
- » Private sunrise hot-tub
- » White oak flooring throughout
- » Wood interior doors with polished nickel hardware throughout
- » Honed Calacatta Gold Quartz slab kitchen island with oak bases
- » Miele (or comparable) oak paneled refrigerator with full-height column and freezer
- » Full-height Sub-Zero wine fridge tower
- » Separate oven, steam oven, convection oven and warming drawer by Miele (or comparable)
- » Laundry rooms include side-by-side front-load washers and dryers and a sink
- » Kohler free-standing soaking tub with Kallista free-standing polished nickel standing tub faucet



SKY VILLA 1

4 BEDROOMS | 4,5 BATHROOMS
LIBRARY | TERRACE | HOT TUB

INTERIOR: 3,627 SF | 337.0 M²
EXTERIOR: 1,650 SF | 153.3 M²
TOTAL: 5,277 SF | 490.3 M²

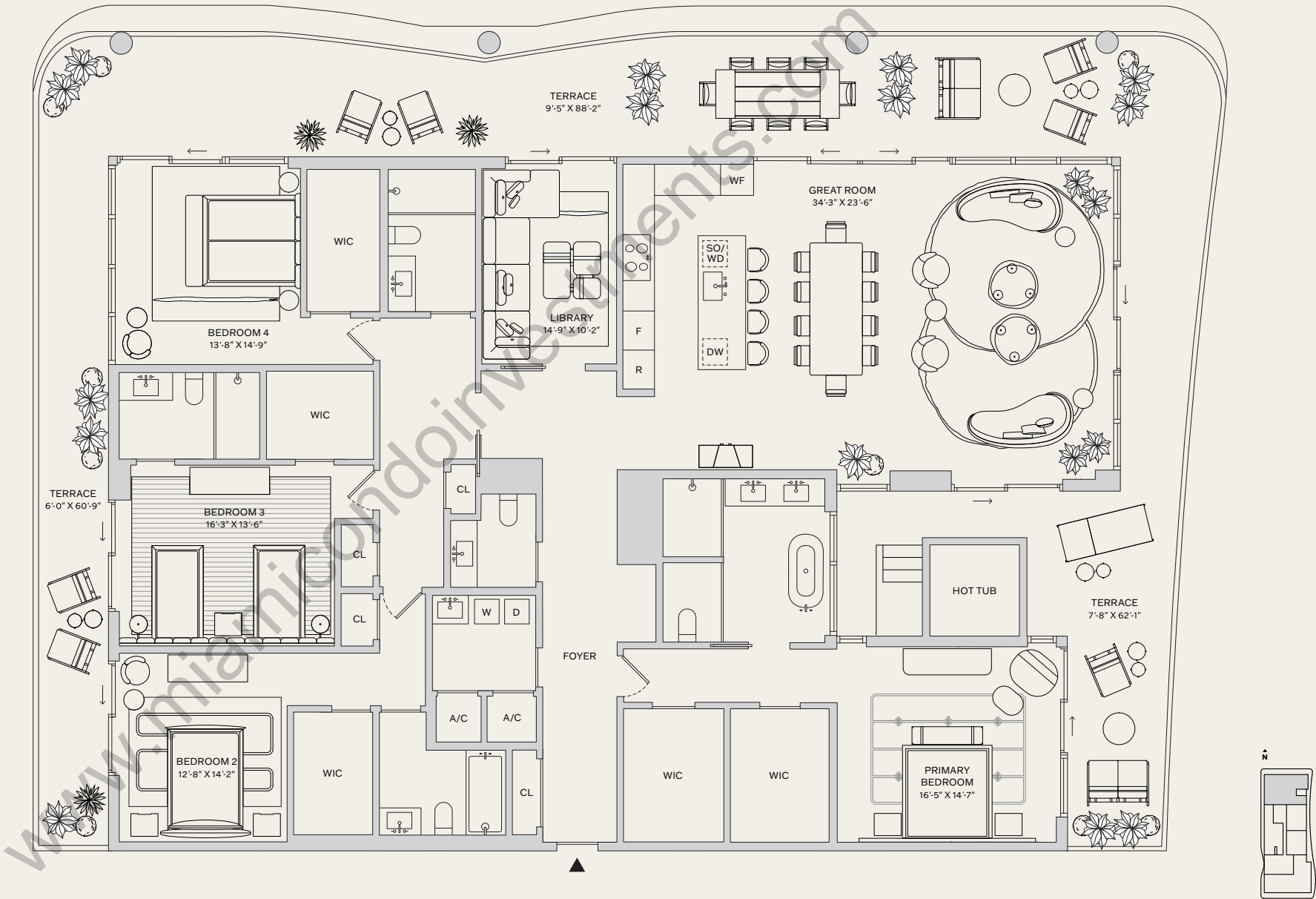

BISCAYNE BAY
NE 2ND AVE

NAFTALI GROUP ONEWORLD PROPERTIES

ORAL REPRESENTATIONS CANNOT BE RELIED UPON AS CORRECTLY STATING THE REPRESENTATIONS OF THE DEVELOPER. FOR CORRECT REPRESENTATIONS, MAKE REFERENCE TO THIS BROCHURE AND TO THE DOCUMENTS REQUIRED BY SECTION 718.503, FLORIDA STATUTES, TO BE FURNISHED BY A DEVELOPER TO A BUYER OR LESSEE. This is not intended to be an offer to sell, or solicitation to buy, condominium units to residents of any jurisdiction where prohibited by law, and your eligibility for purchase will depend upon your state of residency. This offering is made only by the prospectus for the condominium and no statement should be relied upon if not made in the prospectus. The sketches, renderings, graphic materials, plans, specifications, terms, conditions and statements contained in this brochure are proposed only, and the Developer and/or Fendi Casa reserve the right to modify, revise or withdraw any or all of same in its sole discretion and without prior notice. Both Fendi Casa and the Developer reserve the right to make modifications, revisions, and changes to the furniture plans, and list of specified items and certain of the furnishings and other items are subject to size and color variations, grain and quality variations, and may vary in accordance with price, availability and changes from those described or depicted. Not all furniture, fixtures and equipment will be branded by Fendi Casa and items may be omitted. The graphic depictions, or photographs of furnishings, finishes, appliances, counters, soffits, floor coverings, artwork and other matters of detail, including, without limitation, items of finish and decoration are conceptual only, and actual may vary, including variances in color, size, shape, number and placement of items. All floor plans and views are subject to change without notice. All depictions of cabinets, soffits, floor coverings and other matters of detail, including, without limitation, items of finish and decoration, are conceptual only and are not necessarily included in each Unit. The renderings contained in these materials should not be relied upon as a representation of the units. Consult your purchase agreement for the exact items included with the purchase of the Unit. 🏠